



Pressure Regulating Valves



2020 Catalog

Non-Adjustable Pressure Reducing 5400 Series Angle Hose Valves



5480 (Shown with Cap)

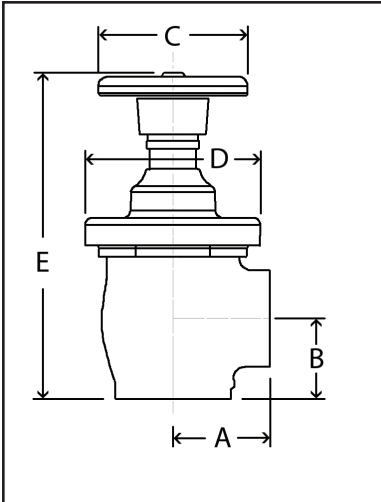

Application:

Automatically regulates pressure under flowing (residual) and non-flowing (static) conditions. Listed for use as a hose connection in Class I, II, and III standpipe systems where inlet pressures require regulation.

Standard Features:

- Angle type cast brass valve with aluminum handle. Made in the USA.
- Female NPT Inlet x Male NH/NST Outlet.
- Tamper proof pressure setting. Pressure settings are factory set and non-adjustable. Flow rate (GPM), static/residual inlet pressures (PSI), and desired static/residual outlet pressures (PSI) are required.

Optional Features:

- Grooved inlet with adapter.
- Optional Finishes: Polished Brass (PB), Rough Chrome (RC), or Polished Chrome (PC).
- Special hose threads on male outlet (Customer to specify).
- Supervisory switch bracket (5500SB).
- Supervisory switch (8152) for remote monitoring.

Approvals:

- 1 1/2" Valves are UL[®]/ULC[®] Listed to 300 PSI for flow rates up to 250 GPM.
- 2 1/2" Valves are UL[®]/ULC[®] Listed to 400 PSI for flow rates up to 500 GPM.
- NYC MEA #388-75-SA.

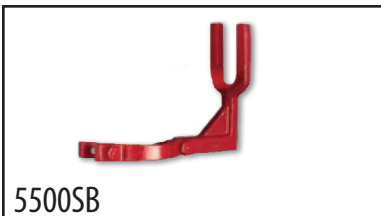

5500SB



8152

Model No.	Size	Type	Inlet	Outlet	A	B	C	D	E (Open)	E (Closed)	Weight (Lbs.)
5460	1 1/2"	Angle	F NPT	M NST	2 3/16"	1 7/8"	4"	3 1/2"	8 1/4"	7 3/4"	7 1/2
5480	2 1/2"	Angle	F NPT	M NST	3 3/8"	2 13/16"	5"	5 7/8"	11 3/8"	10 9/16"	18 1/2



5475

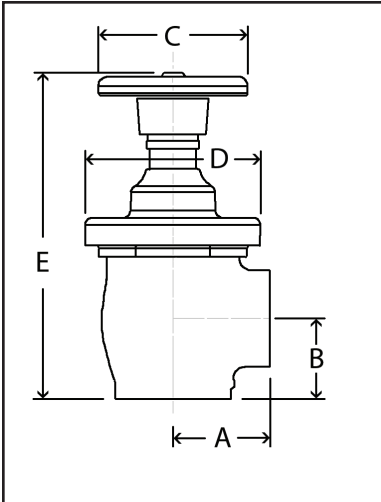

Application:

Automatically regulates pressure under flowing (residual) and non-flowing (static) conditions. Listed for use as a floor control valve, an indicating valve (2 1/2" valves only), and a check valve in automatic sprinkler systems as well as a standpipe valve for Class I, II, and III systems where inlet pressures require regulation.

Standard Features:

- Angle type cast brass valve with aluminum handle. Made in the USA.
- Female NPT Inlet x Female NPT Outlet; Grooved Inlet x Grooved Outlet on Model 5477.
- Tamper proof pressure setting. Pressure settings are factory set and non-adjustable. Flow rate (GPM), static/residual inlet pressures (PSI), and desired static/residual outlet pressures (PSI) are required.
- Visual Indicator for OPEN/CLOSED status on 2 1/2" Valves.

Optional Features:

- Grooved inlet and outlet on Models 5450 & 5455 with adapter.
- Optional Finishes: Polished Brass (PB), Rough Chrome (RC), or Polished Chrome (PC).
- Supervisory switch bracket (5500SB). Comes standard with Models 5455, 5475, & 5477.
- Supervisory switch (8152) for remote monitoring.

Approvals:

- 1 1/2" Valves are UL®/ULC® Listed to 300 PSI for flow rates up to 250 GPM.
- 2 1/2" Valves are UL®/ULC® Listed to 400 PSI for flow rates up to 500 GPM.
- NYC MEA #388-75-SA.

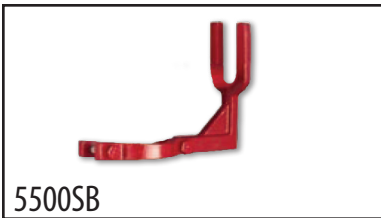

5500SB



8152

Model No.	Size	Type	Inlet	Outlet	A	B	C	D	E (Open)	E (Closed)	Weight (Lbs.)
5450	1 1/2"	Angle	F NPT	F NPT	2 3/16"	1 7/8"	4"	3 1/2"	8 1/4"	7 3/4"	7 1/2
5455	1 1/2"	Angle	F NPT	F NPT	2 3/16"	1 7/8"	4"	3 1/2"	8 1/4"	7 3/4"	7 1/2
5470	2 1/2"	Angle	F NPT	F NPT	3 1/4"	2 13/16"	5"	5 7/8"	11 5/8"	11"	18 1/2
5475	2 1/2"	Angle	F NPT	F NPT	3 1/4"	2 13/16"	5"	5 7/8"	11 5/8"	11"	18 1/2
5477	2 1/2"	Angle	GRV	GRV	3 3/4"	3 5/16"	5"	5 7/8"	12 1/8"	11 1/2"	19 1/2

Note: Call Croker for current listings and approvals. Dimensions and weights shown are approximated and do not include packaging.



PRESSURE REGULATING VALVES

Non-Adjustable Pressure Reducing 5400 Series In-line Control Valves



5495

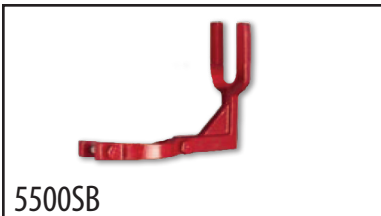
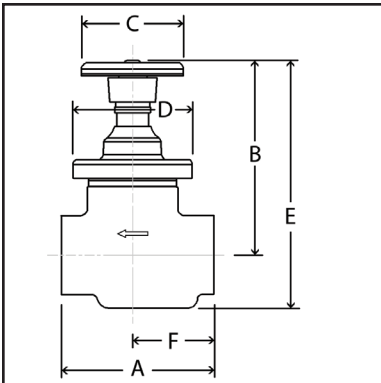

5500SB



8152

Application:

Automatically regulates pressure under flowing (residual) and non-flowing (static) conditions. Listed for use as a floor control valve, an indicating valve, and a check valve in automatic sprinkler systems as well as a standpipe valve for Class I and Class III systems where inlet pressures require regulation.

Standard Features:

- In-line (straight) type cast brass valve with aluminum handle. Made in the USA.
- Female NPT Inlet x Female NPT Outlet; Grooved Inlet x Grooved Outlet.
- Tamper proof pressure setting. Pressure settings are factory set and non-adjustable. Flow rate (GPM), static/residual inlet pressures (PSI), and desired static/residual outlet pressures (PSI) are required.
- Visual Indicator for OPEN/CLOSED status.

Optional Features:

- Optional Finishes: Polished Brass (PB), Rough Chrome (RC), or Polished Chrome (PC).
- Supervisory switch bracket (5500SB). Comes standard with Models 5495 & 5497.
- Supervisory switch (8152) for remote monitoring.

Approvals:

- UL[®]/ULC[®] Listed to 400 PSI for flow rates up to 400 GPM.
- NYC MEA #388-75-SA.

Model No.	Size	Type	Inlet	Outlet	A	B	C	D	E (Open)	E (Closed)	F	Weight (Lbs.)
5490	2 1/2"	In-line	F NPT	F NPT	7 1/2"	10 1/2"	5"	5 7/8"	12 13/16"	12 3/16"	4"	26 1/2
5495	2 1/2"	In-line	F NPT	F NPT	7 1/2"	10 1/2"	5"	5 7/8"	12 13/16"	12 3/16"	4"	28
5497	2 1/2"	In-line	GRV	GRV	8 1/2"	10 1/2"	5"	5 7/8"	12 13/16"	12 3/16"	4 1/2"	31

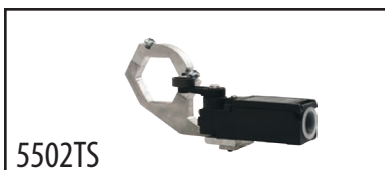
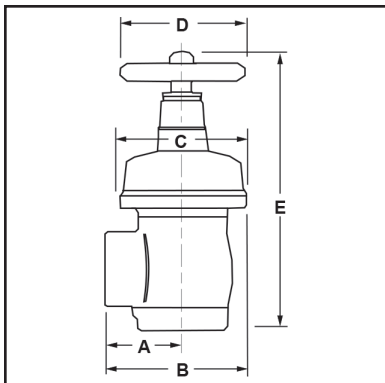

Application:

Automatically regulates pressure under flowing (residual) and non-flowing (static) conditions. Listed for use as a hose connection in Class I, II, and III standpipe systems where inlet pressures require regulation.

Standard Features:

- Angle type cast brass valve with red cast iron handle. Made in the USA.
- Female NPT Inlet x Male NH/NST Outlet; Grooved inlet on Model 5579.
- ¼" Ports (4) drilled, tapped, and plugged on 2 ½" Valves. Install pressure gauges to monitor upstream and downstream pressures.
- Tamper proof pressure setting. Pressure settings are factory set and non-adjustable. Flow rate (GPM), static/residual inlet pressures (PSI), and desired static/residual outlet pressures (PSI) are required.

Optional Features:

- Grooved inlet on Model 5560 with adapter.
- Optional Finishes: Polished Brass (PB), Rough Chrome (RC), or Polished Chrome (PC).
- Special hose threads on male outlet (Customer to specify).
- Supervisory switch bracket (5500SB).
- Supervisory switch (8152) for remote monitoring.
- Built-in supervisory switch (5502TS) for remote monitoring.

Approvals:

- 1 ½" Valves are UL[®]/ULC[®] Listed to 300 PSI for flow rates up to 250 GPM.
- 2 ½" Valves are UL[®]/ULC[®] Listed to 400 PSI for flow rates up to 500 GPM.
- NYC MEA #54-07-E.
- City of Los Angeles Approved.
- City of San Francisco Approved.

Model No.	Size	Type	Inlet	Outlet	A	B	C	D	E (Open)	E (Closed)	Weight (Lbs.)
5560	1 ½"	Angle	F NPT	M NST	2 7/32"	4 5/32"	3 7/8"	3 3/4"	9 25/64"	8 53/64"	9
5579	2 ½"	Angle	GRV	M NST	3 7/32"	6 3/32"	5 3/4"	5 3/4"	11 7/8"	11 5/16"	19
5580	2 ½"	Angle	F NPT	M NST	3 7/32"	6 3/32"	5 3/4"	5 3/4"	11 3/8"	10 13/16"	19

Note: Call Croker for current listings and approvals. Dimensions and weights shown are approximated and do not include packaging.



PRESSURE REGULATING VALVES

Non-Adjustable Pressure Reducing

5500 Series Angle Hose Rack & Control Valves



5570

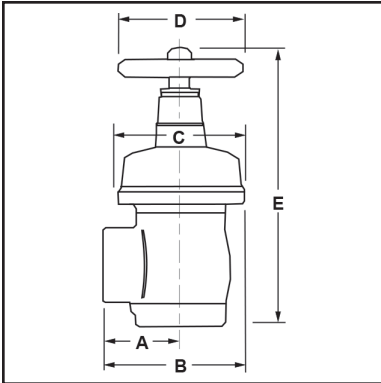

5500SB

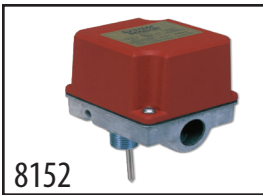

8152

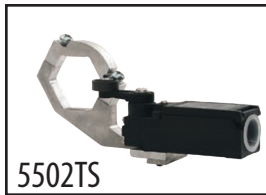

5502TS

Application:

Automatically regulates pressure under flowing (residual) and non-flowing (static) conditions. Listed for use as a floor control valve, an indicating valve (2 1/2" valves only), and a check valve in automatic sprinkler systems as well as a standpipe valve for Class I, II, and III systems where inlet pressures require regulation.

Standard Features:

- Angle type cast brass valve with red cast iron handle. Made in the USA.
- Female NPT Inlet x Female NPT Outlet; Grooved Inlet x Grooved Outlet on Model 5577.
- 1/4" Ports (4) drilled, tapped, and plugged on 2 1/2" Valves. Install pressure gauges to monitor upstream and downstream pressures.
- Tamper proof pressure setting. Pressure settings are factory set and non-adjustable. Flow rate (GPM), static/residual inlet pressures (PSI), and desired static/residual outlet pressures (PSI) are required.
- Visual Indicator for OPEN/CLOSED status on 2 1/2" Valves.

Optional Features:

- Grooved inlet and outlet on Models 5550 & 5555 with adapter.
- Optional Finishes: Polished Brass (PB), Rough Chrome (RC), or Polished Chrome (PC).
- Supervisory switch bracket (5500SB). Comes standard with Models 5555, 5575, & 5577.
- Supervisory switch (8152) for remote monitoring.
- Built-in supervisory switch (5502TS) for remote monitoring.

Approvals:

- 1 1/2" Valves are UL[®]/ULC[®] Listed to 300 PSI for flow rates up to 250 GPM.
- 2 1/2" Valves are UL[®]/ULC[®] Listed to 400 PSI for flow rates up to 500 GPM.
- NYC MEA #54-07-E.
- City of Los Angeles Approved.
- City of San Francisco Approved.

Model No.	Size	Type	Inlet	Outlet	A	B	C	D	E (Open)	E (Closed)	Weight (Lbs.)
5550	1 1/2"	Angle	F NPT	F NPT	2 7/32"	4 5/32"	3 7/8"	3 3/4"	9 25/64"	8 53/64"	9
5555	1 1/2"	Angle	F NPT	F NPT	2 7/32"	4 5/32"	3 7/8"	3 3/4"	9 25/64"	8 53/64"	9
5570	2 1/2"	Angle	F NPT	F NPT	3 7/32"	6 3/32"	5 3/4"	5 3/4"	11 3/8"	10 13/16"	19
5575	2 1/2"	Angle	F NPT	F NPT	3 7/32"	6 3/32"	5 3/4"	5 3/4"	11 3/8"	10 13/16"	19
5577	2 1/2"	Angle	GRV	GRV	3 7/32"	6 3/32"	5 3/4"	5 3/4"	11 7/8"	11 5/16"	19

Note: Call Croker for current listings and approvals. Dimensions and weights shown are approximated and do not include packaging.



5590

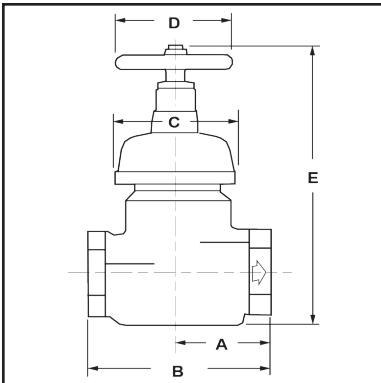

5500SB



8152

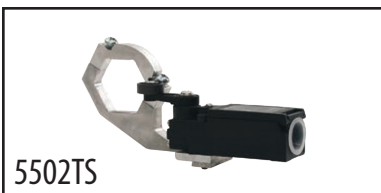

5502TS

Application:

Automatically regulates pressure under flowing (residual) and non-flowing (static) conditions. Listed for use as a floor control valve, an indicating valve, and a check valve in automatic sprinkler systems as well as a standpipe valve for Class I and Class III systems where inlet pressures require regulation.

Standard Features:

- In-line (straight) type cast brass valve with red cast iron handle. Made in the USA.
- Female NPT Inlet x Female NPT Outlet; Grooved Inlet x Grooved Outlet.
- Tamper proof pressure setting. Pressure settings are factory set and non-adjustable. Flow rate (GPM), static/residual inlet pressures (PSI), and desired static/residual outlet pressures (PSI) are required.
- ¼" Ports (4) drilled, tapped, and plugged. Install pressure gauges to monitor upstream and downstream pressures.
- Visual Indicator for OPEN/CLOSED status.

Optional Features:

- Optional Finishes: Polished Brass (PB), Rough Chrome (RC), or Polished Chrome (PC).
- Supervisory switch bracket (5500SB). Comes standard with Models 5595 & 5597.
- Supervisory switch (8152) for remote monitoring.
- Built-in supervisory switch (5502TS) for remote monitoring.

Approvals:

- UL[®] /ULC[®] Listed to 400 PSI for flow rates up to 500 GPM.
- NYC MEA #54-07-E.
- City of Los Angeles Approved.
- City of San Francisco Approved.

Model No.	Size	Type	Inlet	Outlet	A	B	C	D	E (Open)	E (Closed)	Weight (Lbs.)
5590	2 ½"	In-line	F NPT	F NPT	3 7/8"	7 ¾"	5 ¾"	5 ¾"	12 ¾"	12 3/16"	23
5595	2 ½"	In-line	F NPT	F NPT	3 7/8"	7 ¾"	5 ¾"	5 ¾"	12 ¾"	12 3/16"	23
5597	2 ½"	In-line	GRV	GRV	4 3/8"	8 ¾"	5 ¾"	5 ¾"	12 ¾"	12 3/16"	24

Note: Call Croker for current listings and approvals. Dimensions and weights shown are approximated and do not include packaging.



PRESSURE REGULATING VALVES

Non-Adjustable Pressure Reducing 5800 Series Angle Hose Valves



5880

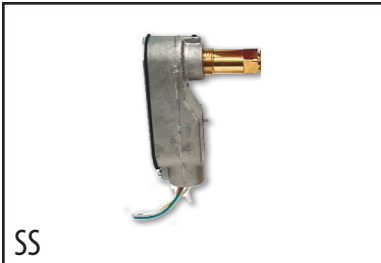
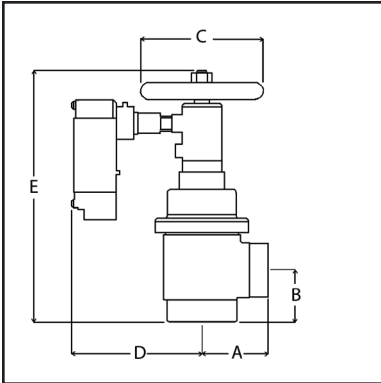

SS

Application:

Automatically regulates pressure under flowing (residual) and non-flowing (static) conditions. Listed for use as a hose connection in Class I, II, and III standpipe systems where inlet pressures require regulation.

Standard Features:

- Angle type cast brass valve with red aluminum handle. Made in China.
- Female NPT Inlet x Male NH/NST Outlet; Grooved inlet on Model 5879.
- Tamper proof pressure setting. Pressure settings are factory set and non-adjustable. Flow rate (GPM), static/residual inlet pressures (PSI), and desired static/residual outlet pressures (PSI) are required.
- ¼" Ports (4) drilled, tapped, and plugged on 2 ½" valves. Install pressure gauges to monitor upstream and downstream pressures.
- Visual Indicator for OPEN/CLOSED status.

Optional Features:

- Grooved inlet on Model 5860 with adapter.
- Optional Finishes: Polished Brass (PB), Rough Chrome (RC), or Polished Chrome (PC).
- Special hose threads on male outlet (Customer to specify).
- Built-in supervisory switch (SS) for remote monitoring. Valves with this option do not have a visual indicator.

Approvals:

- 1 ½" Valves are UL[®]/ULC[®] Listed to 300 PSI for flow rates up to 250 GPM.
- 2 ½" Valves are UL[®]/ULC[®] Listed to 400 PSI for flow rates up to 500 GPM.

Model No.	Size	Type	Inlet	Outlet	A	B	C	D	E (Open)	E (Closed)	Weight (Lbs.)
5860	1 ½"	Angle	F NPT	M NST	2 7/8"	1 7/8"	4 3/8"	n/a	9 5/8"	9"	8
5860-SS	1 ½"	Angle	F NPT	M NST	2 7/8"	1 7/8"	4 3/8"	4 9/16"	9 5/8"	9"	9
5879	2 ½"	Angle	GRV	M NST	3 1/8"	3 13/16"	6 5/8"	n/a	12 1/4"	11 11/16"	20
5879-SS	2 ½"	Angle	GRV	M NST	3 1/8"	3 13/16"	6 5/8"	4 9/16"	13 13/16"	13 1/16"	21
5880	2 ½"	Angle	F NPT	M NST	3 1/8"	2 5/8"	6 5/8"	n/a	11 1/8"	10 1/2"	19
5880-SS	2 ½"	Angle	F NPT	M NST	3 1/8"	2 5/8"	6 5/8"	4 9/16"	12 11/16"	11 15/16"	20



5870

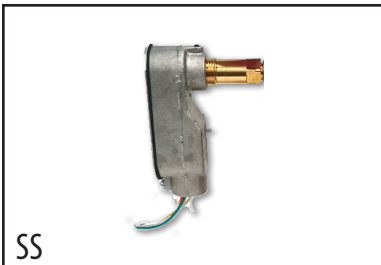
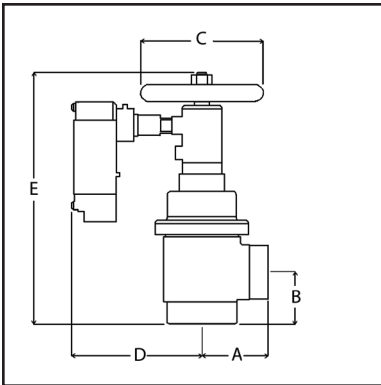

SS

Application:

Automatically regulates pressure under flowing (residual) and non-flowing (static) conditions. Listed for use as a floor control valve, an indicating valve, and a check valve in automatic sprinkler systems as well as a standpipe valve for Class I, II, and III systems where inlet pressures require regulation.

Standard Features:

- Angle type cast brass valve with red aluminum handle. Made in China.
- Female NPT Inlet x Female NPT Outlet; Grooved Inlet x Grooved Outlet.
- Tamper proof pressure setting. Pressure settings are factory set and non-adjustable. Flow rate (GPM), static/residual inlet pressures (PSI), and desired static/residual outlet pressures (PSI) are required.
- ¼" Ports (4) drilled, tapped, and plugged on 2 ½" valves. Install pressure gauges to monitor upstream and downstream pressures.
- Visual Indicator for OPEN/CLOSED status.

Optional Features:

- Optional Finishes: Polished Brass (PB), Rough Chrome (RC), or Polished Chrome (PC).
- Built-in supervisory switch (SS) for remote monitoring. Valves with this option do not have a visual indicator.

Approvals:

- 1 ½" Valves are UL[®]/ULC[®] Listed to 300 PSI for flow rates up to 250 GPM.
- 2 ½" Valves are UL[®]/ULC[®] Listed to 400 PSI for flow rates up to 500 GPM.

Model No.	Size	Type	Inlet	Outlet	A	B	C	D	E (Open)	E (Closed)	Weight (Lbs.)
5850	1 ½"	Angle	F NPT	F NPT	2 ¼"	1 ⅞"	4 ⅜"	n/a	9 ⅝"	9"	8
5850-SS	1 ½"	Angle	F NPT	F NPT	2 ¼"	1 ⅞"	4 ⅜"	4 ⅞"	9 ⅝"	9"	9
5857	1 ½"	Angle	GRV	GRV	2 ⅞"	2 ¾"	4 ⅜"	n/a	10 ½"	9 ⅞"	9
5857-SS	1 ½"	Angle	GRV	GRV	2 ⅞"	2 ¾"	4 ⅜"	4 ⅞"	10 ½"	9 ⅞"	10
5870	2 ½"	Angle	F NPT	F NPT	3 ⅞"	2 ⅝"	6 ⅝"	n/a	11 ⅞"	10 ½"	19
5870-SS	2 ½"	Angle	F NPT	F NPT	3 ⅞"	2 ⅝"	6 ⅝"	4 ⅞"	12 ⅞"	11 ⅞"	20
5877	2 ½"	Angle	GRV	GRV	4 ⅝"	3 ⅞"	6 ⅝"	n/a	12 ¼"	11 ½"	21
5877-SS	2 ½"	Angle	GRV	GRV	4 ⅝"	3 ⅞"	6 ⅝"	4 ⅞"	13 ⅞"	13 ⅞"	22

Note: Call Croker for current listings and approvals. Dimensions and weights shown are approximated and do not include packaging.



PRESSURE REGULATING VALVES

Non-Adjustable Pressure Reducing 5800 Series In-line Control Valves

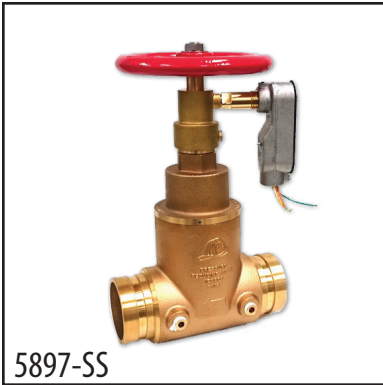

5897-SS

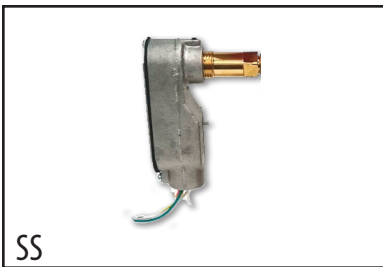
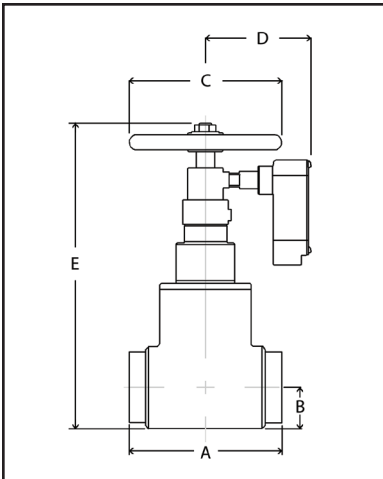

SS

Application:

Automatically regulates pressure under flowing (residual) and non-flowing (static) conditions. Listed for use as a floor control valve, an indicating valve, and a check valve in automatic sprinkler systems as well as a standpipe valve for Class I and Class III systems where inlet pressures require regulation.

Standard Features:

- In-line (straight) type cast brass valve with red aluminum handle. Made in China.
- Female NPT Inlet x Female NPT Outlet; Grooved Inlet x Grooved Outlet.
- Tamper proof pressure setting. Pressure settings are factory set and non-adjustable. Flow rate (GPM), static/residual inlet pressures (PSI), and desired static/residual outlet pressures (PSI) are required.
- ¼" Ports (4) drilled, tapped, and plugged. Install pressure gauges to monitor upstream and downstream pressures.
- Visual Indicator for OPEN/CLOSED status.

Optional Features:

- Optional Finishes: Polished Brass (PB), Rough Chrome (RC), or Polished Chrome (PC).
- Built-in supervisory switch (SS) for remote monitoring. Valves with this option do not have a visual indicator.

Approvals:

- 1 ½" Valves are UL[®]/ULC[®] Listed to 300 PSI for flow rates up to 250 GPM.
- 2 ½" Valves are UL[®]/ULC[®] Listed to 400 PSI for flow rates up to 500 GPM.

Model No.	Size	Type	Inlet	Outlet	A	B	C	D	E (Open)	E (Closed)	Weight (Lbs.)
5890	2 ½"	In-line	F NPT	F NPT	6 ¾"	1 7/8"	6 5/8"	n/a	11 ¾"	11"	21
5890-SS	2 ½"	In-line	F NPT	F NPT	6 ¾"	1 7/8"	6 5/8"	4 9/16"	13 1/8"	12 3/8"	22
5897	2 ½"	In-line	GRV	GRV	7 ½"	1 13/16"	6 5/8"	n/a	11 9/16"	10 13/16"	20
5897-SS	2 ½"	In-line	GRV	GRV	7 ½"	1 13/16"	6 5/8"	4 9/16"	13 1/8"	12 3/8"	21



5960

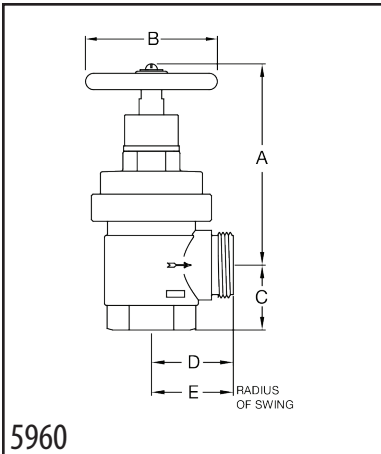

5960

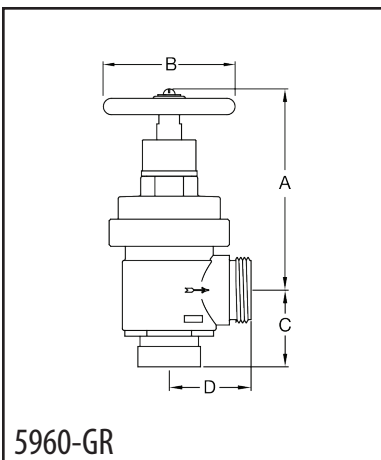

5960-GR

Application:

Automatically regulates pressure under flowing (residual) and non-flowing (static) conditions. Listed for use as a hose connection in Class II standpipe systems where inlet pressures require regulation.

Standard Features:

- Angle type cast bronze valve with red handle. Made in the USA.
- Female NPT Inlet x Male NH/NST Outlet.
- Tamper proof pressure setting. Pressure settings are factory set and non-adjustable. Flow rate (GPM), static/residual inlet pressures (PSI), and desired static/residual outlet pressures (PSI) are required.

Optional Features:

- Grooved Inlet (GR).
- Optional Finishes: Polished (PB), Rough Chrome (RC), or Polished Chrome (PC).
- Special hose threads on male outlet (Customer to specify).

Approvals:

- UL[®]/ULC[®] Listed to 400 PSI for flow rates up to 200 GPM.

Model No.	Size	Type	Inlet	Outlet	A (Open)	A (Closed)	B	C	D	E	Weight (Lbs.)
5960	1 1/2"	Angle	F NPT	M NST	6 3/4"	6 1/8"	4"	2"	2 1/2"	2 5/8"	9
5960-GR	1 1/2"	Angle	GRV	M NST	6 3/4"	6 1/8"	4"	2 3/8"	2 1/2"	n/a	9

Note: Call Croker for current listings and approvals. Dimensions and weights shown are approximated and do not include packaging.



PRESSURE REGULATING VALVES

Non-Adjustable Pressure Reducing

5900 Series Angle Hose Rack & Control Valves



5950

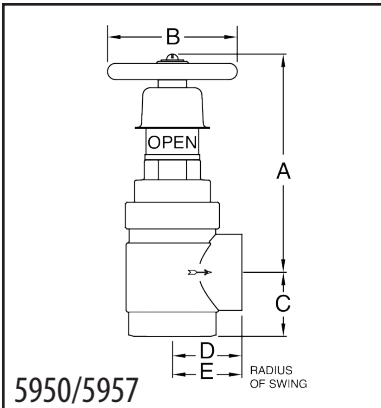

5950/5957

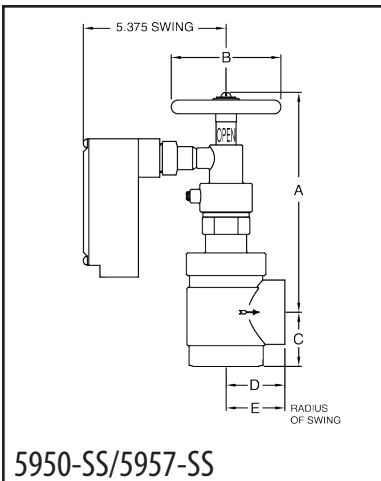

5950-SS/5957-SS

Application:

Automatically regulates pressure under flowing (residual) and non-flowing (static) conditions. Listed for use as a floor control valve, an indicating valve, and a check valve in automatic sprinkler systems as well as a standpipe valve for Class II systems where inlet pressures require regulation.

Standard Features:

- Angle type cast bronze valve with red handle. Made in the USA.
- Female NPT Inlet x Female NPT Outlet; Grooved Inlet x Grooved Outlet.
- Tamper proof pressure setting. Pressure settings are factory set and non-adjustable. Flow rate (GPM), static/residual inlet pressures (PSI), and desired static/residual outlet pressures (PSI) are required.
- Visual Indicator for OPEN/CLOSED status.

Optional Features:

- Optional Finishes: Polished (PB), Rough Chrome (RC), or Polished Chrome (PC).
- Built-in supervisory switch (SS) for remote monitoring.
- Capped bonnet (CAP). No handwheel assembly.

Approvals:

- UL[®]/ULC[®] Listed to 400 PSI for flow rates up to 200 GPM.
- California State Fire Marshall Listed (with SS).

Model No.	Size	Type	Inlet	Outlet	A (Open)	A (Closed)	B	C	D	E	Weight (Lbs.)
5950	1 1/2"	Angle	F NPT	F NPT	6 3/4"	6 1/8"	4"	2"	2 3/16"	2 3/16"	9
5950-SS	1 1/2"	Angle	F NPT	F NPT	6 3/4"	6 1/8"	4"	2"	2 3/16"	2 3/16"	11
5957	1 1/2"	Angle	GRV	GRV	6 3/4"	6 1/8"	4"	2 3/8"	2 1/2"	n/a	9
5957-SS	1 1/2"	Angle	GRV	GRV	6 3/4"	6 1/8"	4"	2 3/8"	2 1/2"	n/a	11



5980

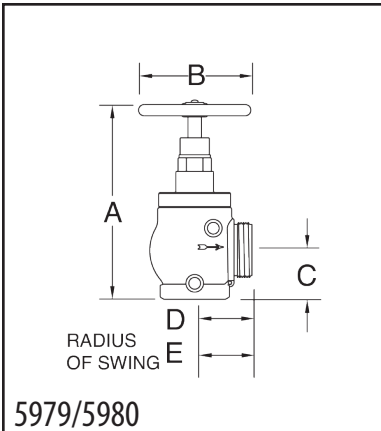

5979/5980

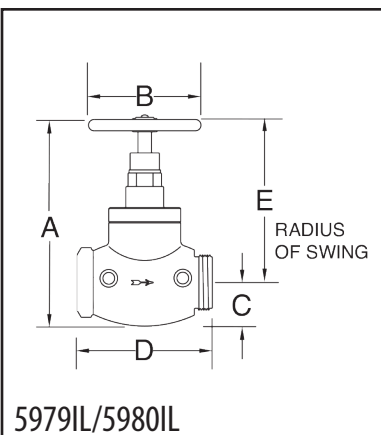

5979IL/5980IL

Application:

Automatically regulates pressure under flowing (residual) and non-flowing (static) conditions. Listed for use as a hose connection in Class I and Class III standpipe systems where inlet pressures require regulation.

Standard Features:

- Angle type cast bronze valve with red handle. Made in the USA.
- Female NPT Inlet x Male NH/NST Outlet; Grooved Inlet x Male NH/NST Outlet.
- Tamper proof pressure setting. Pressure settings are factory set and non-adjustable. Flow rate (GPM), static/residual inlet pressures (PSI), and desired static/residual outlet pressures (PSI) are required.
- ¼" Ports (4) drilled, tapped, and plugged. Install pressure gauges to monitor upstream and downstream pressures.

Optional Features:

- In-line (straight) type (IL).
- Optional Finishes: Polished (PB), Rough Chrome (RC), or Polished Chrome (PC).
- Special hose threads on male outlet (Customer to specify).

Approvals:

- UL[®]/ULC[®] Listed to 400 PSI for flow rates to 500 GPM.
- NYC MEA #325-06-E.
- City of Los Angeles Approved.

Model No.	Size	Type	Inlet	Outlet	A (Open)	A (Closed)	B	C	D	E	Weight (Lbs.)
5979	2 ½"	Angle	GRV	M NST	11 5/16"	10 7/16"	6 ¼"	3 5/16"	3 3/16"	3 ½"	18
5979IL	2 ½"	In-line	GRV	M NST	11 ½"	10 ½"	6 ¼"	2 3/8"	8 ¾"	8 3/16"	23
5980	2 ½"	Angle	F NPT	M NST	10 7/8"	10"	6 ¼"	2 ¾"	3 3/16"	3 ½"	19
5980IL	2 ½"	In-line	F NPT	M NST	11 ½"	10 ½"	6 ¼"	2 3/8"	7 ½"	8 3/16"	23

Note: Call Croker for current listings and approvals. Dimensions and weights shown are approximated and do not include packaging.



PRESSURE REGULATING VALVES

Non-Adjustable Pressure Reducing

5900 Series Angle Hose Rack & Control Valves



5977



5977-SS

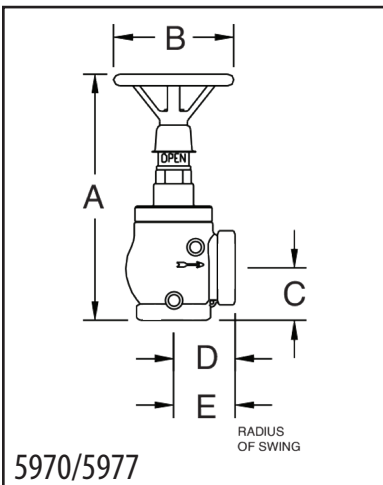

5970/5977

Application:

Automatically regulates pressure under flowing (residual) and non-flowing (static) conditions. Listed for use as a floor control valve, an indicating valve, and a check valve in automatic sprinkler systems as well as a standpipe valve for Class I and Class III systems where inlet pressures require regulation.

Standard Features:

- Angle type cast bronze valve with red handle. Made in the USA.
- Female NPT Inlet x Female NPT Outlet; Grooved Inlet x Grooved Outlet.
- Tamper proof pressure setting. Pressure settings are factory set and non-adjustable. Flow rate (GPM), static/residual inlet pressures (PSI), and desired static/residual outlet pressures (PSI) are required.
- ¼" Ports (4) drilled, tapped, and plugged. Install pressure gauges to monitor upstream and downstream pressures.
- Visual Indicator for OPEN/CLOSED status.



8152

Optional Features:

- Optional Finishes: Polished (PB), Rough Chrome (RC), or Polished Chrome (PC).
- Monitor Switch Bracket (MSA).
- Supervisory switch (8152) for remote monitoring.
- Built-in supervisory switch (SS) for remote monitoring.
- Capped bonnet (CAP). No handwheel assembly.

Approvals:

- UL[®]/ULC[®] Listed to 400 PSI for flow rates up to 500 GPM.
- NYC MEA #325-06-E.
- City of Los Angeles Approved.
- California State Fire Marshall Listed (with SS).

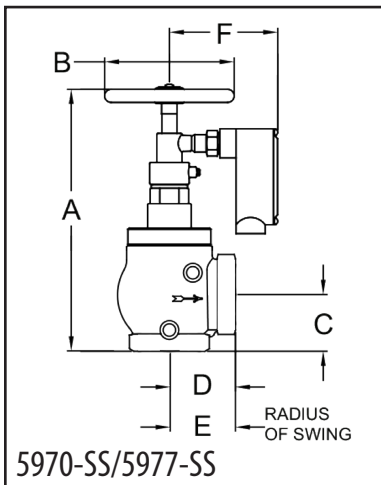

5970-SS/5977-SS

Model No.	Size	Type	Inlet	Outlet	A (Open)	A (Closed)	B	C	D	E	F	Weight (Lbs.)
5970	2 ½"	Angle	F NPT	F NPT	12 7/8"	12"	6 ¼"	2 ¾"	3 3/16"	3 5/8"	n/a	20
5970-SS	2 ½"	Angle	F NPT	F NPT	12 7/8"	12"	6 ¼"	2 ¾"	3 3/16"	3 5/8"	5 ½"	21
5977	2 ½"	Angle	GRV	GRV	13 5/16"	12 7/16"	6 ¼"	3 3/16"	3 3/16"	n/a	n/a	19
5977-SS	2 ½"	Angle	GRV	GRV	13 5/16"	12 7/16"	6 ¼"	3 3/16"	3 3/16"	n/a	5 ½"	20



5990MSA

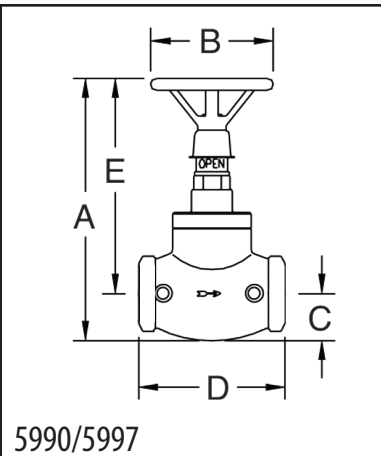

5990/5997

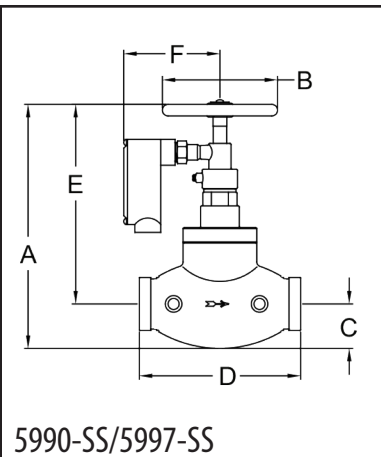

5990-SS/5997-SS

Application:

Automatically regulates pressure under flowing (residual) and non-flowing (static) conditions. Listed for use as a floor control valve, an indicating valve, and a check valve in automatic sprinkler systems as well as a standpipe valve for Class I and Class III systems where inlet pressures require regulation.

Standard Features:

- In-line (straight) type cast bronze valve with red handle. Made in the USA.
- Female NPT Inlet x Female NPT Outlet; Grooved Inlet x Grooved Outlet.
- Tamper proof pressure setting. Pressure settings are factory set and non-adjustable. Flow rate (GPM), static/residual inlet pressures (PSI), and desired static/residual outlet pressures (PSI) are required.
- ¼" Ports (4) drilled, tapped, and plugged. Install pressure gauges to monitor upstream and downstream pressures.
- Visual Indicator for OPEN/CLOSED status.

Optional Features:

- Optional Finishes: Polished (PB), Rough Chrome (RC), or Polished Chrome (PC).
- Monitor Switch Bracket (MSA).
- Supervisory switch (8152) for remote monitoring.
- Built-in supervisory switch (SS) for remote monitoring.
- Capped bonnet (CAP). No handwheel assembly.

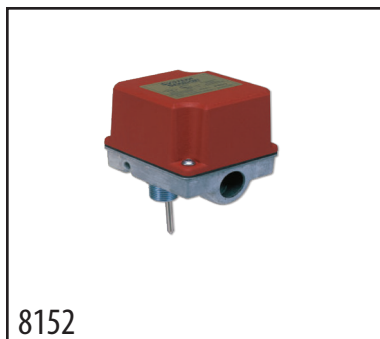

8152

Approvals:

- UL[®]/ULC[®] Listed to 400 PSI for flow rates up to 500 GPM.
- NYC MEA #325-06-E.
- City of Los Angeles Approved.
- California State Fire Marshall Listed (with SS).

Model No.	Size	Type	Inlet	Outlet	A (Open)	A (Closed)	B	C	D	E	F	Weight (Lbs.)
5990	2 ½"	In-line	F NPT	F NPT	13 ½"	12 ½"	6 ¼"	2 ¾"	7 ½"	8 ⅜"	n/a	24
5990-SS	2 ½"	In-line	F NPT	F NPT	13 ½"	12 ½"	6 ¼"	2 ¾"	7 ½"	11"	5 ½"	25
5997	2 ½"	In-line	GRV	GRV	13 ½"	12 ½"	6 ¼"	2 ¾"	8 ¾"	n/a	n/a	24
5997-SS	2 ½"	In-line	GRV	GRV	13 ½"	12 ½"	6 ¼"	2 ¾"	8 ¾"	n/a	5 ½"	25

Note: Call Croker for current listings and approvals. Dimensions and weights shown are approximated and do not include packaging.



PRESSURE REGULATING VALVES

Field Adjustable Pressure Reducing 5400 Series Angle Hose Valves



5410

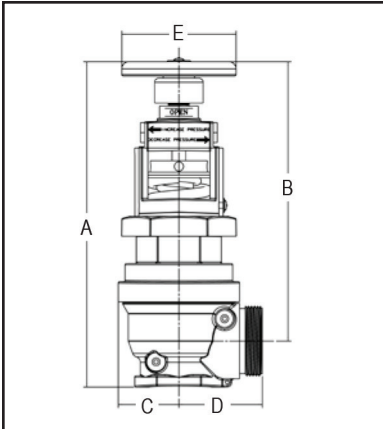

Application:

Automatically regulates pressure under flowing (residual) and non-flowing (static) conditions. Listed for use as a hose connection in Class I and Class III standpipe systems where inlet pressures require regulation.

Standard Features:

- Angle type cast brass valve with red aluminum handle. Made/assembled in the USA or China.
- Female NPT Inlet x Male NH/NST Outlet.
- Low torque manual open/close handle.
- Low torque field adjustable pressure setting easily determined with color coded indication label.
- Tamper resistant protective shroud.
- ¼" Ports (4) drilled, tapped, and plugged. Install pressure gauges to monitor upstream and downstream pressures.
- Visual Indicator for OPEN/CLOSED status.
- Setting rod included with each valve.
- Size & weight permits installation in 1700 Series Cabinet (18" x 18" x 8").

Optional Features:

- Optional Finishes: Polished Brass (PB), Rough Chrome (RC), or Polished Chrome (PC).
- Grooved inlet with adapter.
- Special hose threads on male outlet (Customer to specify).

Approvals:

- UL[®]/ULC[®] Listed to 400 PSI for flow rates up to 500 GPM.
- NYC MEA # 352-91-M.
- City of Denver Approved.

Model No.	Size	Type	Inlet	Outlet	A (Open)	A (Closed)	B	C	D	E	F	Weight (Lbs.)
5410	2 ½"	Angle	F NPT	M NST	14 ¼"	13 ⅝"	12 ¼"	2 ⅝"	3 ⅝"	5"	4 ¼"	28 ½

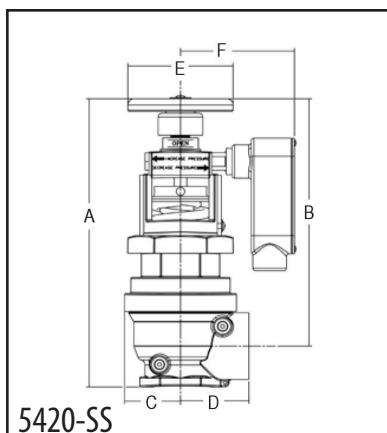
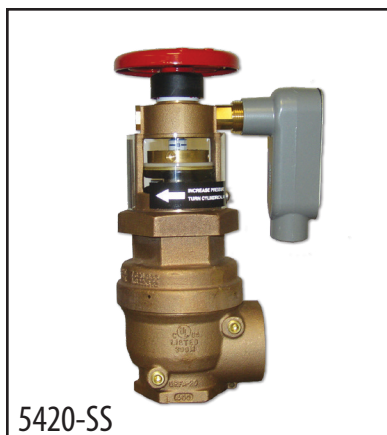

Application:

Automatically regulates pressure under flowing (residual) and non-flowing (static) conditions. Listed for use as a floor control valve, an indicating valve, and a check valve in automatic sprinkler systems as well as for use in Class I and Class III standpipe systems where inlet pressures require regulation.

Standard Features:

- Angle type cast brass valve with red aluminum handle. Made/assembled in the USA or China.
- Female NPT Inlet x Female NPT Outlet; Grooved Inlet x Grooved Outlet.
- Low torque manual open/close handle.
- Low torque field adjustable pressure setting easily determined with color coded indication label.
- Tamper resistant protective shroud.
- ¼" Ports (4) drilled, tapped, and plugged. Install pressure gauges to monitor upstream and downstream pressures.
- Visual Indicator for OPEN/CLOSED status.
- Setting rod included with each valve.
- Size & weight permits installation in tighter areas and smaller hose cabinets.

Optional Features:

- Optional Finishes: Polished Brass (PB), Rough Chrome (RC), or Polished Chrome (PC).
- Capped bonnet. No handwheel assembly. Comes standard on Model 5428.
- Built-in supervisory switch (SS) for remote monitoring.

Approvals:

- UL[®]/ULC[®] Listed to 400 PSI for flow rates up to 500 GPM.
- NYC MEA # 352-91-M.
- City of Denver Approved.

Model No.	Size	Type	Inlet	Outlet	A (Open)	A (Closed)	B	C	D	E	F	Weight (Lbs.)
5420	2 ½"	Angle	F NPT	F NPT	14 ¼"	13 ⅝"	12 ¼"	2 ⅝"	3 ¼"	5"	4 ¼"	28 ½
5427	2 ½"	Angle	GRV	GRV	15 ⅛"	15 ⅛"	12 ¼"	2 ⅝"	4 ⅛"	5"	4 ¼"	30 ½
5428	2 ½"	Angle	F NPT	F NPT	14 ¼"	13 ⅝"	12 ¼"	2 ⅝"	3 ¼"	5"	4 ¼"	28 ½

Note: Call Croker for current listings and approvals. Dimensions and weights shown are approximated and do not include packaging.



PRESSURE REGULATING VALVES

Field Adjustable Pressure Reducing 5400 Series In-line Control Valves

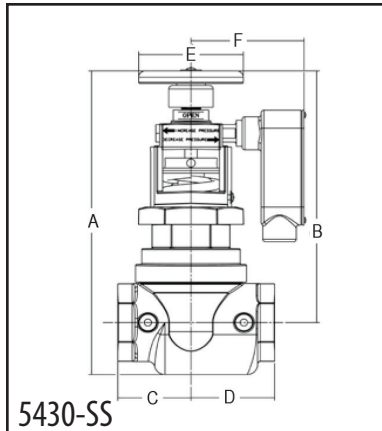
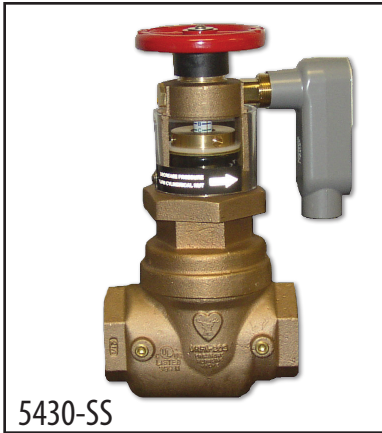

Application:

Automatically regulates pressure under flowing (residual) and non-flowing (static) conditions. Listed for use as a floor control valve, an indicating valve, and a check valve in automatic sprinkler systems as well as a standpipe valve for Class I and Class III systems where inlet pressures require regulation.

Standard Features:

- In-line (Straight) type cast brass valve with red aluminum handle. Made/assembled in the USA or China.
- Female NPT Inlet x Female NPT Outlet; Grooved Inlet x Grooved Outlet.
- Low torque manual open/close handle.
- Low torque field adjustable pressure setting easily determined with color coded indication label.
- Tamper resistant protective shroud.
- ¼" Ports (4) drilled, tapped, and plugged. Install pressure gauges to monitor upstream and downstream pressures.
- Visual Indicator for OPEN/CLOSED status.
- Setting rod included with each valve.
- Size & weight permits installation in tighter areas.

Optional Features:

- Optional Finishes: Polished (PB), Rough Chrome (RC), or Polished Chrome (PC).
- Capped bonnet. No handwheel assembly. Comes standard on Model 5438.
- Built-in supervisory switch (SS) for remote monitoring.

Approvals:

- UL[®]/ULC[®] Listed to 400 PSI for flow rates up to 500 GPM.
- NYC MEA # 352-91-M.
- City of Denver Approved.

Model No.	Size	Type	Inlet	Outlet	A (Open)	A (Closed)	B	C	D	E	F	Weight (Lbs.)
5430	2 ½"	In-line	F NPT	F NPT	15 ½"	14 ½"	12 ¼"	3 ½"	3 ¼"	5"	4 ¼"	34 ½
5437	2 ½"	In-line	GRV	GRV	15 ½"	14 ½"	12 ¼"	4 15/16"	4 11/16"	5"	4 ¼"	37 ½
5438	2 ½"	In-line	F NPT	F NPT	15 ½"	14 ½"	12 ¼"	3 ½"	3 ¼"	5"	4 ¼"	34 ½



5610

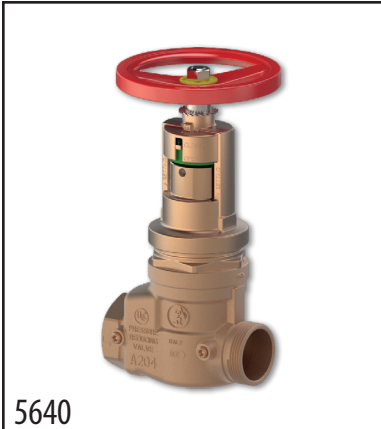

5640

Application:

Automatically regulates pressure under flowing (residual) and non-flowing (static) conditions. Listed for use as a hose connection in Class I and Class III standpipe systems where inlet pressures require regulation.

Standard Features:

- Angle type or In-line (straight) cast bronze valve with red aluminum handle. Made in Italy.
- Female NPT Inlet x Male NH/NST Outlet.
- Tamper resistant field adjustable pressure setting.
- ¼" Ports (4) drilled, tapped, and plugged. Install pressure gauges to monitor upstream and downstream pressures.
- Visual Indicator at bonnet for OPEN/CLOSED status.
- Setting rod included with each valve.

Optional Features:

- Optional Finishes: Polished (PB), Rough Chrome (RC), or Polished Chrome (PC).
- Special hose threads on male outlet (Customer to specify).

Approvals:

- UL[®]/ULC[®] Listed to 400 PSI for flow rates up to 500 GPM.

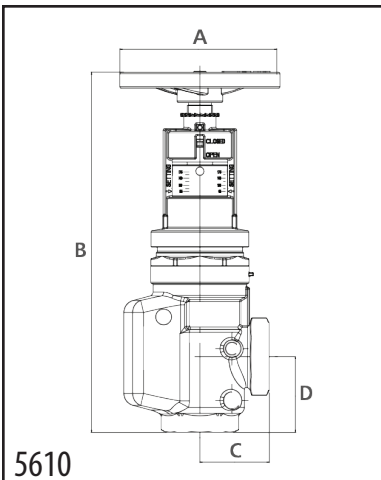

5610

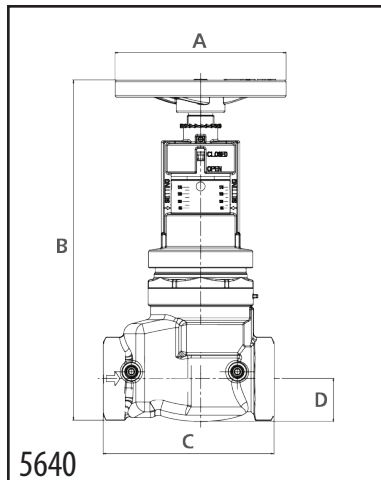

5640

Model No.	Size	Type	Inlet	Outlet	A	B (Open)	B (Closed)	C	D	Weight (Lbs.)
5610	2 ½"	Angle	F NPT	M NST	7 ⅞"	18 ¼"	17 ¼"	3 ½"	3 ¾"	35
5640	2 ½"	In-line	F NPT	M NST	7 ⅞"	15 ⅜"	15 ⅝"	8"	2"	34

Note: Call Croker for current listings and approvals. Dimensions and weights shown are approximated and do not include packaging.



PRESSURE REGULATING VALVES

Field Adjustable Pressure Reducing 5600 Series Angle Hose Rack & Control Valves

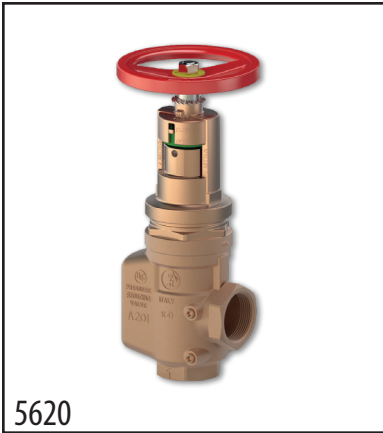

Application:

Automatically regulates pressure under flowing (residual) and non-flowing (static) conditions. Listed for use as a floor control valve, an indicating valve, and a check valve in automatic sprinkler systems as well as a standpipe valve for Class I and Class III systems where inlet pressures require regulation.

Standard Features:

- Angle type cast bronze valve with red aluminum handle. Made in Italy.
- Female NPT Inlet x Female NPT Outlet; Grooved Inlet x Grooved Outlet.
- Tamper resistant field adjustable pressure setting.
- ¼" Ports (4) drilled, tapped, and plugged. Install pressure gauges to monitor upstream and downstream pressures.
- Visual Indicator at bonnet for OPEN/CLOSED status.
- Setting rod included with each valve.

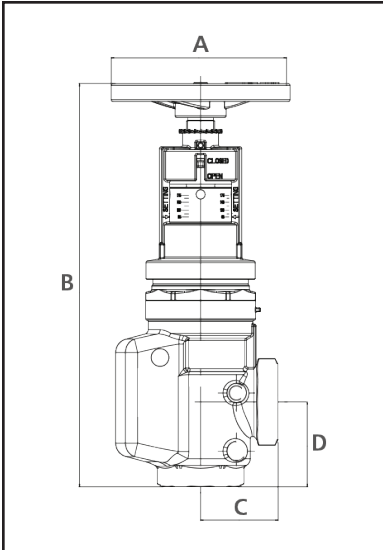

Optional Features:

- Optional Finishes: Polished (PB), Rough Chrome (RC), or Polished Chrome (PC).
- Capped bonnet. No handwheel assembly.
- Supervisory switch bracket (5647). Comes standard with Models 5625 & 5627.
- Supervisory switch (8152) for remote monitoring.

Approvals:

- UL[®] /ULC[®] Listed to 400 PSI for flow rates up to 500 GPM.

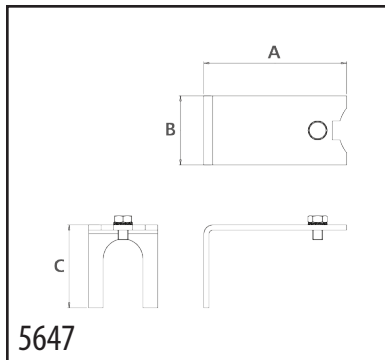

Model No.	A	B	C
5647	3 ¼"	1 ⅝"	1 ⅞"

Model No.	Size	Type	Inlet	Outlet	A	B (Open)	B (Closed)	C	D	Weight (Lbs.)
5620	2 ½"	Angle	F NPT	F NPT	7 ⅞"	18 ¼"	17 ¼"	3 ½"	3 ¾"	35
5625	2 ½"	Angle	F NPT	F NPT	7 ⅞"	18 ¼"	17 ¼"	3 ½"	3 ¾"	35
5627	2 ½"	Angle	GRV	GRV	7 ⅞"	19 ½"	18 ½"	4 ¾"	5"	35

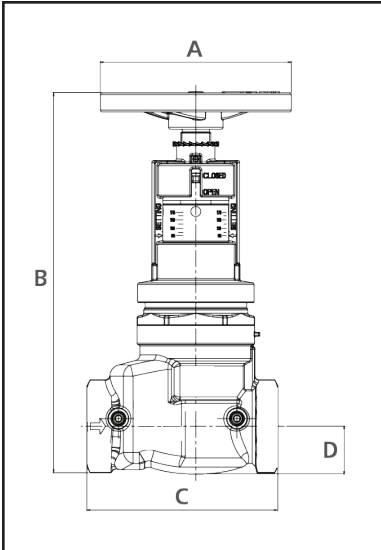
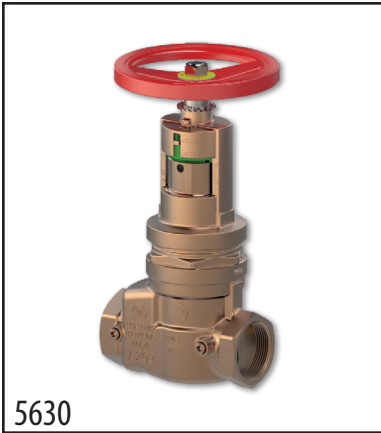

Application:

Automatically regulates pressure under flowing (residual) and non-flowing (static) conditions. Listed for use as a floor control valve, an indicating valve, and a check valve in automatic sprinkler systems as well as a standpipe valve for Class I and Class III systems where inlet pressures require regulation.

Standard Features:

- In-line (straight) type cast bronze valve with red aluminum handle. Made in Italy.
- Female NPT Inlet x Female NPT Outlet; Grooved Inlet x Grooved Outlet.
- Tamper resistant field adjustable pressure setting.
- ¼" Ports (4) drilled, tapped, and plugged. Install pressure gauges to monitor upstream and downstream pressures.
- Visual Indicator at bonnet for OPEN/CLOSED status.
- Setting rod included with each valve.

Optional Features:

- Optional Finishes: Polished (PB), Rough Chrome (RC), or Polished Chrome (PC).
- Capped bonnet. No handwheel assembly.
- Supervisory switch bracket (5647). Comes standard with Models 5635 & 5637.
- Supervisory switch (8152) for remote monitoring.

Approvals:

- UL[®] /ULC[®] Listed to 400 PSI for flow rates up to 500 GPM.

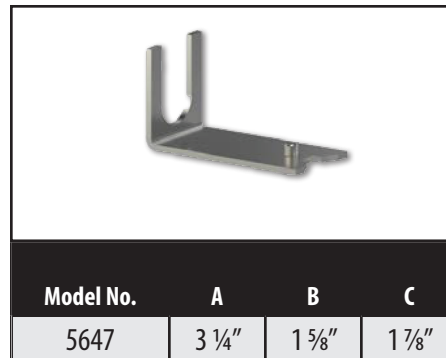
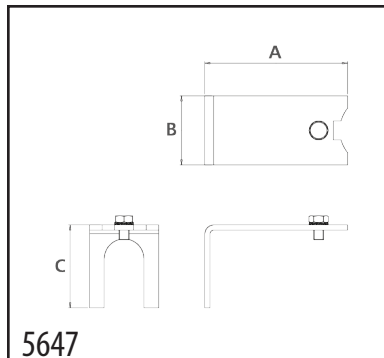

Model No.	Size	Type	Inlet	Outlet	A	B (Open)	B (Closed)	C	D	Weight (Lbs.)
5630	2 ½"	In-line	F NPT	F NPT	7 ⅞"	15 ⅜"	15 ⅝"	7 ⅞"	2"	34
5635	2 ½"	In-line	F NPT	F NPT	7 ⅞"	15 ⅜"	15 ⅝"	7 ⅞"	2"	34
5637	2 ½"	In-line	GRV	GRV	7 ⅞"	15 ⅜"	15 ⅝"	10 ½"	2"	34

Note: Call Croker for current listings and approvals. Dimensions and weights shown are approximated and do not include packaging.

Field Adjustable Pressure Reducing 5900 Series Angle Hose & Hose Rack Valves



5900

Application:

Automatically regulates pressure under flowing (residual) and non-flowing (static) conditions. Listed for use as a standpipe valve for individual hose stations in Class II systems, where inlet pressures require regulation.

Standard Features:

- Angle type cast bronze valve with red handle. Made in the USA.
- Female NPT Inlet x Female NPT Outlet; Female NPT Inlet x Male NH/NST Outlet.
- Tamper resistant pressure setting can be adjusted and set at the factory or set in the field without draining the standpipe riser.



5905

Optional Features:

- Optional Finishes: Polished (PB), Rough Chrome (RC), or Polished Chrome (PC).
- Special hose threads on male outlet (Customer to specify).

Approvals:

- UL[®]/ULC[®] Listed to 400 PSI for flow rates up to 200 GPM.
- City of Los Angeles Approved.

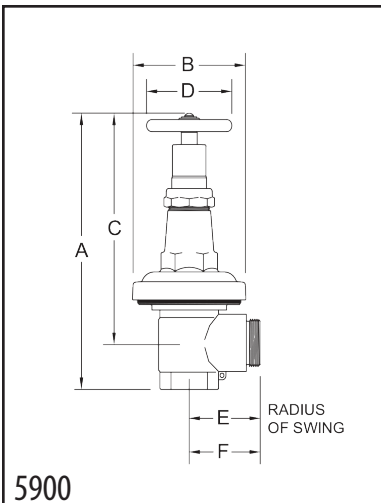

5900

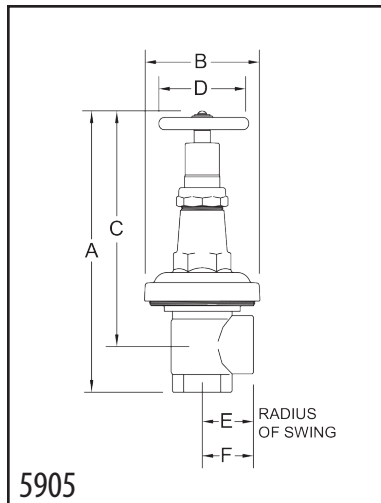

5905

Model No.	Size	Type	Inlet	Outlet	A (Open)	A (Closed)	B	C	D	E	F	Weight (Lbs.)
5900	1 1/2"	Angle	F NPT	M NST	11 1/2"	11 1/4"	5 1/4"	9 3/4"	4"	3 1/2"	3 1/4"	13
5905	1 1/2"	Angle	F NPT	F NPT	11 1/2"	11 1/4"	5 1/4"	9 3/4"	4"	2 3/4"	2 1/2"	14



5910

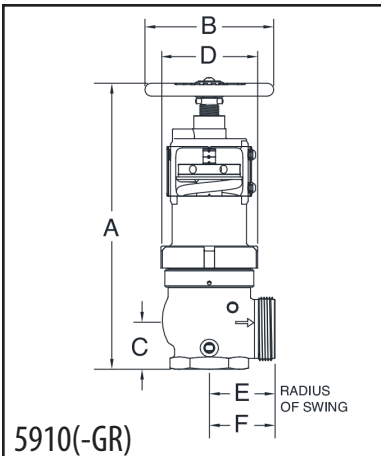

5910(-GR)

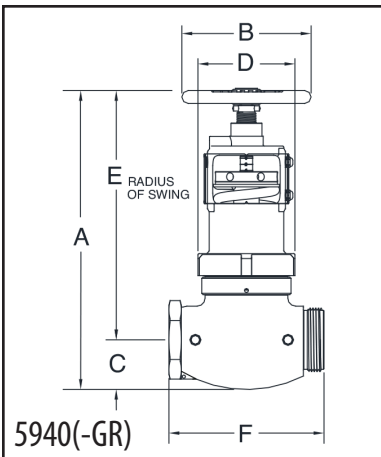

5940(-GR)

Application:

Automatically regulates pressure under flowing (residual) and non-flowing (static) conditions. Listed for use as a hose connection in Class I and Class III standpipe systems where inlet pressures require regulation.

Standard Features:

- Angle or In-line (straight) type cast bronze valve with red handle. Made in the USA.
- Female NPT Inlet x Male NH/NST Outlet.
- Low torque takes only 9 ft lb of force to field adjust under flow or no-flow conditions.
- Tamper resistant pressure setting can be adjusted and set at the factory or set in the field.
- Tamper-proof shield easily breaks away for on-the-fly adjustments in cases of emergency.
- ¼" Ports (4) drilled, tapped, and plugged. Install pressure gauges to monitor upstream and downstream pressures.
- Setting rod included with each valve.
- Size & weight permits installation in 1700 Series Cabinet (18" x 18" x 8").

Optional Features:

- Grooved inlet (GR).
- Optional Finishes: Polished (PB), Rough Chrome (RC), or Polished Chrome (PC).
- Special hose threads on male outlet (Customer to specify).

Approvals:

- UL[®]/ULC[®] Listed to 400 PSI for flow rates up to 500 GPM.

Model No.	Size	Type	Inlet	Outlet	A (Open)	A (Closed)	B	C	D	E	F	Weight (Lbs.)
5910	2 ½"	Angle	F NPT	M NST	13 7/8"	13 3/8"	6 ¼"	2"	5"	3 ½"	3 ¼"	23
5910-GR	2 ½"	Angle	GRV	M NST	14 ½"	14"	6 ¼"	2 ½"	5"	n/a	3 ¼"	23
5940	2 ½"	In-line	F NPT	M NST	14 ½"	14"	6 ¼"	2 ½"	5"	12 7/16"	7 ½"	27
5940-GR	2 ½"	In-line	GRV	M NST	14 ½"	14"	6 ¼"	2 ½"	5"	n/a	8 ¾"	27

Note: Call Croker for current listings and approvals. Dimensions and weights shown are approximated and do not include packaging.



PRESSURE REGULATING VALVES

Field Adjustable Pressure Reducing 5900 Series Angle & In-line Hose Rack Valves

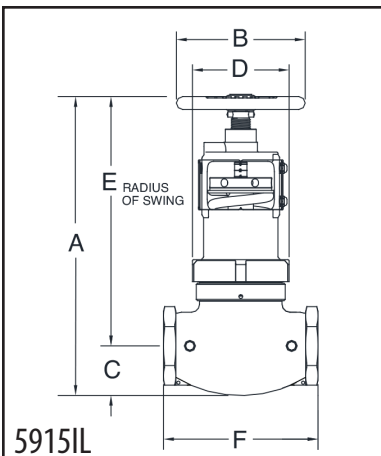
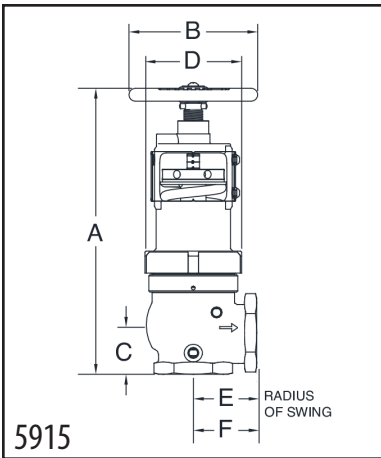

Application:

Automatically regulates pressure under flowing (residual) and non-flowing (static) conditions. Listed for use as a standpipe valve for individual hose stations in Class I and Class III systems, where inlet pressures require regulation.

Standard Features:

- Angle type cast bronze valve with red handle. Made in the USA.
- Female NPT Inlet x Female NPT Outlet.
- Low torque takes only 9 ft lb of force to field adjust under flow or no-flow conditions.
- Tamper resistant pressure setting can be adjusted and set at the factory or set in the field.
- Tamper-proof shield easily breaks away for on-the-fly adjustments in cases of emergency.
- ¼" Ports (4) drilled, tapped, and plugged. Install pressure gauges to monitor upstream and downstream pressures.
- Setting rod included with each valve.
- Size & weight permits installation in tighter areas and smaller hose cabinets.

Optional Features:

- In-line (straight) type (IL).
- Optional Finishes: Polished (PB), Rough Chrome (RC), or Polished Chrome (PC).

Approvals:

- UL[®]/ULC[®] Listed to 400 PSI for flow rates up to 500 GPM.

Model No.	Size	Type	Inlet	Outlet	A (Open)	A (Closed)	B	C	D	E	F	Weight (Lbs.)
5915	2 ½"	Angle	F NPT	F NPT	13 7/8"	13 ¼"	6 ¼"	2"	5"	3 ½"	3 1/16"	23
5915IL	2 ½"	In-line	F NPT	F NPT	14 ½"	14"	6 ¼"	2 ½"	5"	12 7/16"	7 ½"	27



5937

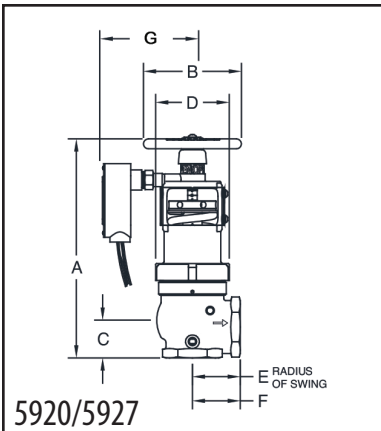

5920/5927

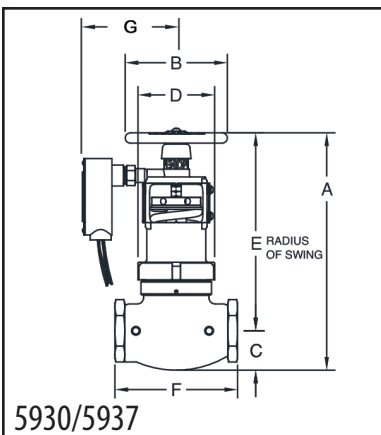

5930/5937

Application:

Automatically regulates pressure under flowing (residual) and non-flowing (static) conditions. Listed for use as a floor control valve, an indicating valve, and a check valve in automatic sprinkler systems as well as a standpipe valve for Class I and Class III systems where inlet pressures require regulation.

Standard Features:

- Angle or In-line (straight) type cast bronze valve with red handle. Made in the USA.
- Female NPT Inlet x Female NPT Outlet; Grooved Inlet x Grooved Outlet.
- Built-in supervisory switch for remote monitoring. Normally open contacts are standard.
- Low torque takes only 9 ft lb of force to field adjust under flow or no-flow conditions.
- Tamper resistant pressure setting can be adjusted and set at the factory or set in the field.
- Tamper-proof shield easily breaks away for on-the-fly adjustments in cases of emergency.
- ¼" Ports (4) drilled, tapped, and plugged. Install pressure gauges to monitor upstream and downstream pressures.
- Visual Indicator for OPEN/CLOSED status.
- Setting rod included with each valve.
- Size & weight permits installation in tighter areas and smaller cabinets.

Optional Features:

- Optional Finishes: Polished (PB), Rough Chrome (RC), or Polished Chrome (PC).
- Capped bonnet (CAP). No handwheel assembly.

Approvals:

- UL[®]/ULC[®] Listed to 400 PSI for flow rates up to 500 GPM.

Model No.	Size	Type	Inlet	Outlet	A (Open)	A (Closed)	B	C	D	E	F	G	Weight (Lbs.)
5920-SS	2 ½"	Angle	F NPT	F NPT	13 7/8"	13 3/8"	6 ¼"	2"	5"	3 ½"	3 ¼"	5 ¾"	23
5927-SS	2 ½"	Angle	GRV	GRV	14 ½"	14"	6 ¼"	2 ½"	5"	n/a	3 ¼"	5 ¾"	23
5930-SS	2 ½"	In-line	F NPT	F NPT	14 ½"	14"	6 ¼"	2 ½"	5"	12 7/16"	7 ½"	5 ¾"	27
5937-SS	2 ½"	In-line	GRV	GRV	14 ½"	14"	6 ¼"	2 ½"	5"	n/a	8 ¾"	n/a	27

Note: Call Croker for current listings and approvals. Dimensions and weights shown are approximated and do not include packaging.

**Pilot Operated Pressure Reducing
ZW209FP Series Control Valve**



ZW209FPG

Application:

The Model ZW209FP Pilot Operated Pressure Reducing Valve is designed specifically for Fire Suppression Systems to reduce high inlet pressures to a safe and stable outlet pressure. The pilot assembly reacts to changes in downstream pressure allowing the main valve to modulate between the closed and open position ensuring a constant downstream set pressure. Once the downstream pressure reaches the pilot setting, the main valve will seal shut preventing damage downstream. Pressure regulation is not dependent upon flow rate, resulting in minimal pressure loss through the valve. In addition the Models ZW209FP and ZW209FPG come standard with red epoxy coating internally and externally for corrosion protection, as well as isolation valves and pressure gauges for quick and easy maintenance or repair.

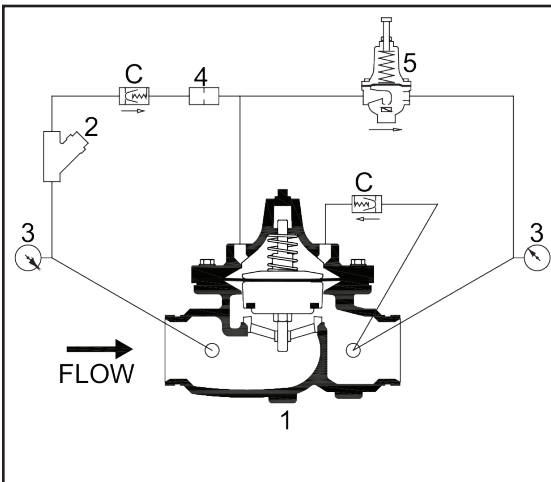

Standard Features:

- Ductile Iron ASTM A536 Main Valve Body & Cover, Bronze ASTM B 176 Disc Guide & Seat, Buna-N Rubber Disc, Nylon Reinforced Buna-N Diaphragm, and Stainless Steel Stem & Spring. Red Epoxy Coating (FDA Approved). Made in the USA.
- "Wye" type strainer.
- Inlet and Outlet Pressure Gauges (UL/FM).
- 3-Way Gauge Isolation Valves.
- ANSI Class 300 Flanged Ends available 1 1/2" thru 10".
- 33°F to 140°F Water Temperature Rating.
- 50-165 PSI Residual Pressure Pilot Spring Range (155 PSI Max 10").

Optional Features:

- Grooved Ends (G), available 1 1/2" thru 10" (Inlet rating to 300 PSI).
- NPT Threaded Ends (TH), available 1 1/4" thru 3" (Inlet rating to 300 PSI).
- ANSI Class 150 Flanged Ends (X), available 1 1/2" thru 10" (Inlet rating to 250 PSI).
- 40XL Hydraulic Check (C).
- Pilot on reverse side (RV).

Approvals:

- UL®/ULC® Listed to 300 PSI (ANSI Class 150 listed to 250 PSI).

Item No.	Description
1	Main Valve
2	SXL "Wye" Type Strainer
3	Pressure Gauge
4	Restriction Fitting
5	PV-PRD Pressure Reducing Control
C	40XL Hydraulic Check

Operation:

The Model ZW209FP utilizes a pressure reducing pilot valve that installs on the discharge side of the control circuitry. The pilot is a direct acting, normally open, spring loaded, diaphragm actuated valve. The operation of the ZW209FP begins with accurately sizing the valve, then fine tuning the control circuit by adjusting the pilot spring to the desired downstream pressure. Inlet pressure is piped to the inlet port of the pressure reducing pilot. A sensing line runs internally from the discharge side of the pilot to its lower control chamber under the diaphragm. Thus, downstream pressure exceeding the preset acts to close the pilot while the adjustable spring seeks to keep it open. The result is a modulating action in the pilot that is transmitted to the cover of the main valve. This creates a mirror modulation of the diaphragm assembly in the main valve. Downstream pressure is maintained within narrow limits regardless of changing flow rates or varying inlet pressures.

Note: Call Croker for current listings and approvals. Dimensions and weights shown are approximated and do not include packaging.

PRESSURE REGULATING VALVES



Pilot Operated Pressure Reducing ZW209FP Series Control Valve

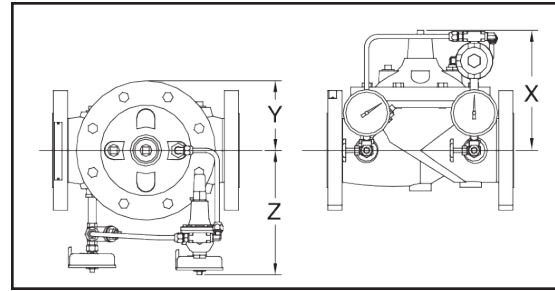
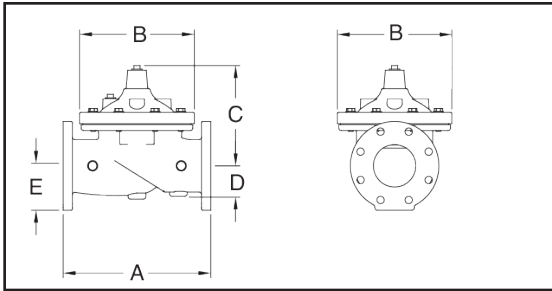

DIM	DESCRIPTION	VALVE SIZE								
		1 1/4"	1 1/2"	2"	2 1/2"	3"	4"	6"	8"	10"
A	THREADED (TH)	7 1/4"	7 1/4"	9 7/16"	11"	12 1/2"	n/a	n/a	n/a	n/a
A	CLASS 150 FLANGE (X)	n/a	8 1/2"	9 3/8"	11"	12"	15"	20"	25 3/8"	29 3/4"
A	CLASS 300 FLANGE	n/a	9"	10"	11 5/8"	13 1/4"	15 5/8"	21"	26 7/16"	31 1/8"
A	GROOVED (G)	n/a	8 1/2"	9"	11"	12 1/2"	15"	20"	25 3/8"	29 3/4"
B	DIAMETER	5 5/8"	5 5/8"	6 3/4"	8 1/16"	9 3/16"	11 1/16"	15 3/4"	20 1/8"	23 1/16"
C	MAX.	5 3/4"	5 3/4"	6 3/16"	7 3/8"	8 1/8"	10 3/16"	12 5/16"	15 9/16"	17 5/8"
D	MAX.	1 3/8"	1 3/8"	1 3/4"	2 1/8"	2 9/16"	3 7/16"	4 15/16"	5"	5 13/16"
E	CLASS 150 FLANGE (X)	n/a	2 1/2"	3"	3 1/2"	3 3/4"	4 1/2"	5 1/2"	6 3/4"	8"
E	CLASS 300 FLANGE	n/a	3 1/16"	3 1/4"	3 3/4"	4 1/8"	5"	6 1/4"	7 1/2"	8 3/4"
X	MAX.	8 3/4"	8 3/4"	8 3/4"	8 3/4"	9 3/4"	10"	12 13/16"	15 3/8"	17 5/8"
Y	MAX.	2 7/8"	2 7/8"	3 1/2"	4"	4 1/2"	6"	8"	10"	12"
Z	MAX.	9 1/8"	9 1/8"	9 1/2"	9"	9 1/2"	10"	12 1/4"	13 3/4"	15 1/2"
Wt.	Approx. in Lbs.	23	25	35	50	70	140	285	500	700

Flow Characteristics

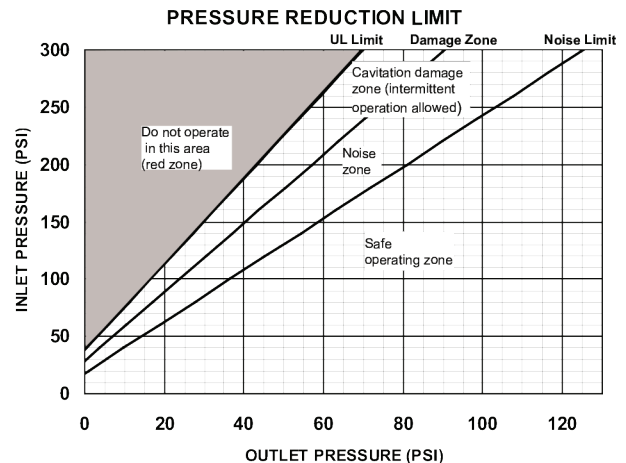
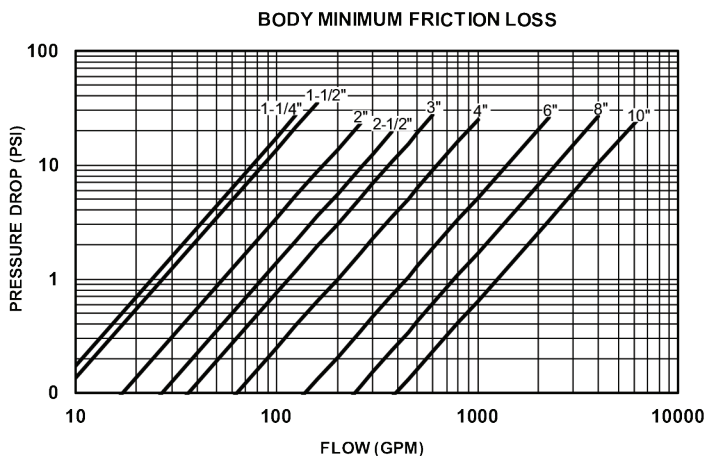

Notes for Body Minimum Friction Loss Chart: Minimum inlet pressure is 10 psi higher than set point or the additional body friction loss at intended flow, whichever is higher. When inlet pressure is below set point, the outlet pressure will be the pressure at the inlet minus the friction loss.

Note: Call Croker for current listings and approvals. Dimensions and weights shown are approximated and do not include packaging.



Croker has provided exceptional service and the finest quality fire hose & standpipe equipment since 1911. Croker offers UL/FM FDCs, Rack Hose/Assemblies, Hose Valves, Direct Acting & Pilot Operated PRVs, ITM Equipment, UL Storz Connections, Riser Packs, Extinguishers, Nitrogen Systems, Industrial Hose & Monitors, Sprinkler Accessories, Adapters, Custom Manifolds and more!

CROKER

**FIRE-END & CROKER CORPORATION
7 WESTCHESTER PLAZA
ELMSFORD, NY 10523
INFO@CROKER.COM
WWW.CROKER.COM
(800) 759-FIRE (PHONE)
(914) 592-3892 (FAX)**