

Figure No. 6405

**SINGLE CLAPPER TWO-WAY INLETS**

An exposed auxiliary inlet connection with 500 G.P.M. inlet capacity to supplement fire protection water supply. Exposed design provides an economical method of satisfying Fire Dept. inlet requirements.

**STANDARD EQUIPMENT:** Cast brass two-way inlet body only with single swing clapper and pin lug swivel back or angle outlet connection as selected by figure number.

**SPECIFY THREAD.**

**BRANDING:** "Auto Spkr." **FINISH:** Cast Brass

**\*U/L LISTED**

**OPTIONAL FINISHES:**

PB - Polished Brass

RC - Rough Chrome Plated

PC - Polished Chrome Plated

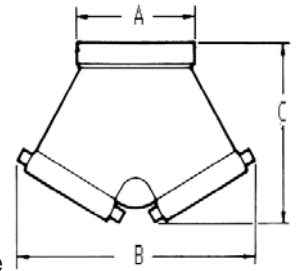

6405 Back Outlet



Figure No. 6407

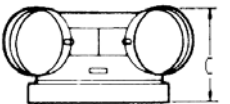
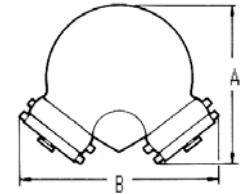

6407 Angle Outlet

Model	Outlet Style	Dimensions		
		A	B	C
6405	Back	5 1/4	8 5/64	6 1/2
6407	Angle	6 5/16	7 11/16	4 3/4

**DOUBLE CLAPPER TWO-WAY INLETS**



Figure No. 6410-6415

An exposed auxiliary inlet connection with 500 G.P.M. Inlet capacity to supplement fire protection water supply. Exposed design provides an economical method of satisfying Fire Department Inlet requirements.

**STANDARD EQUIPMENT:** Cast brass two-way inlet body only with double drop clappers and pin lug swivels; back or angle outlet connection as selected by figure number. Branding as selected. **SPECIFY THREAD AND BRANDING.**

**BRANDING:** "Standpipe", "Auto Spkr."

**FINISH:** Cast Brass

**OPTIONAL FINISHES:**

PB - Polished Brass

RC - Rough Chrome Plated

PC - Polished Chrome Plated



6410 Back Outlet



Figure No. 6420-6425

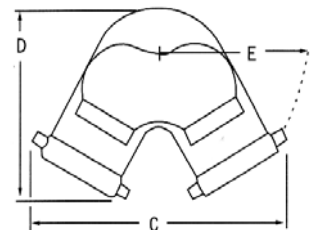

6420 Angle Outlet

**\*U/L LISTED**

**NY BSA-MEA APPROVED**

Outlet Style		Size	Dimensions				
Back	Angle		A	B	C	D	E
*6410		4 X 2 1/2 X 2 1/2	9 5/8	12 1/4			
	6420	4 X 2 1/2 X 2 1/2			11 3/4	9 5/8	7 1/4
6412		6 X 2 1/2 X 2 1/2	10 1/4	11 3/4			
	6422	6 X 2 1/2 X 2 1/2			12 1/2	10 1/8	7 1/2
6413		4 X 3 X 3	10	12 1/2			
	6423	4 X 3 X 3			12 1/2	10 1/8	7 1/2
6414		5 X 3 X 3	10 1/8	12 1/2			
	6424	5 X 3 X 3			12 1/4	10 1/2	7 1/2
6415		6 X 3 X 3	10 3/8	12 1/2			
	6425	6 X 3 X 3			12 1/4	10 7/8	7 1/4